

# PITMEC

## THE PCON-E 165 CONCENTRIC UNDERREAMING SYSTEM

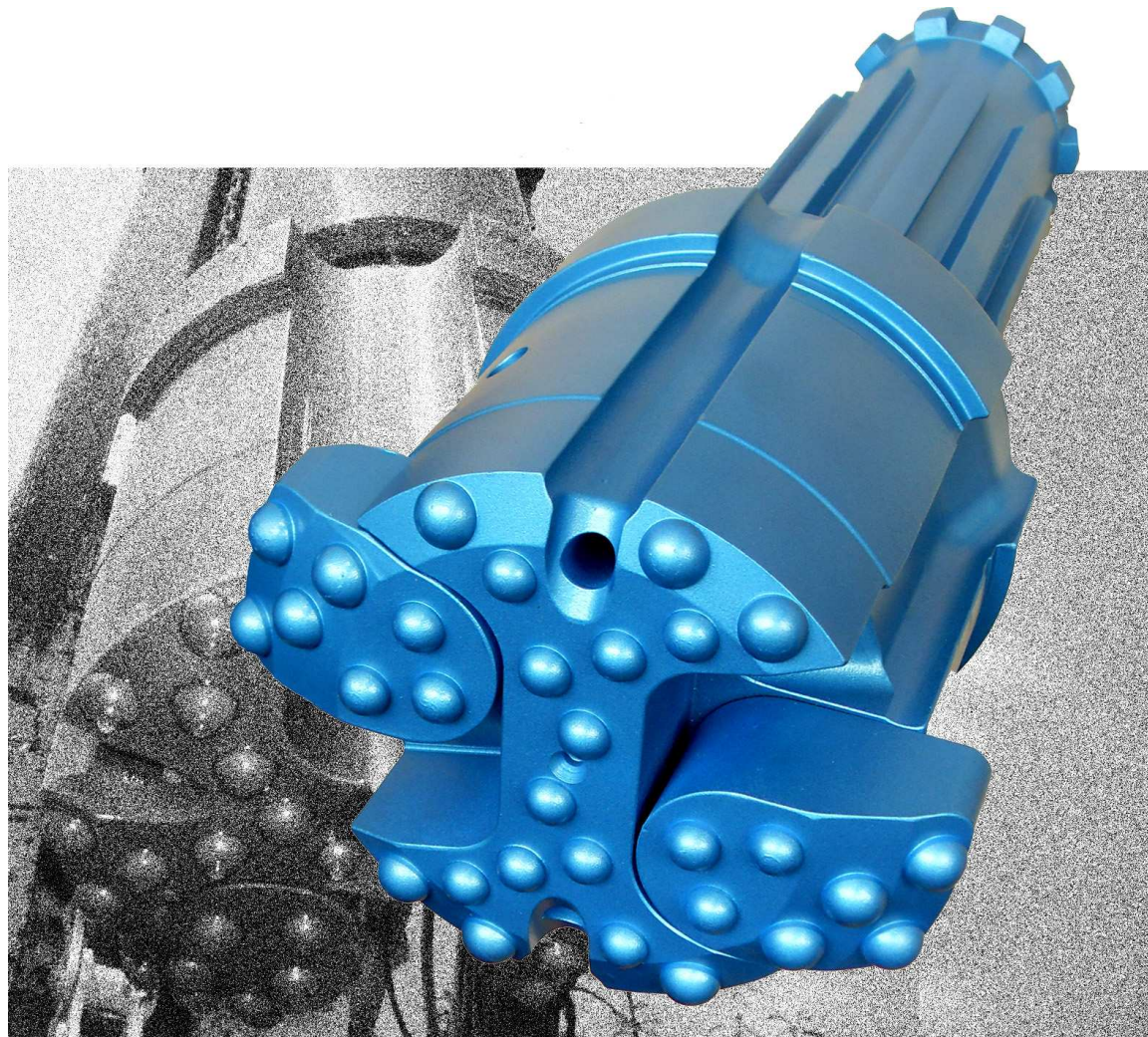

---

**CASING SIZE 194MM OD X 181MM ID DRILLING DIA. 215MM**

# PNEUMEC PCON-E 165 CONCENTRIC UNDERREAMING SYSTEM

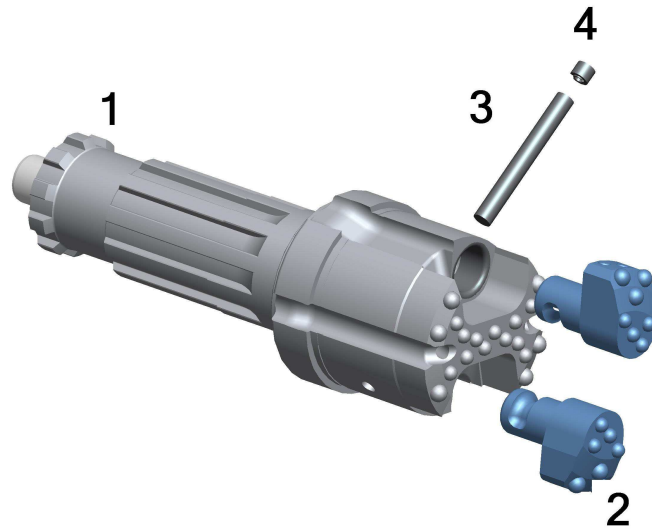

## PCON-E 165 PARTS LIST

1.	DRIVER BIT DHD360 SHANK	UGD165360PCE
2.	REAMER(2)	UBS165PCE
3.	LOCKING PIN	USP16550PCE
4.	SPLIT PIN	USP16551PCE
5.	COMPLETE SYSTEM	UCS165360PCE

## PCON-E 165 SPECIFICATIONS

UPPER BODY DIAMETER	178MM	CLOSED DIAMETER	165MM
REAMING DIAMETER	215MM	CASING SIZE	194MM OD X 181MM ID
SYSTEM LENGTH	527MM	SYSTEM WEIGHT	60KG

## PCON-E 165 CASING SHOES

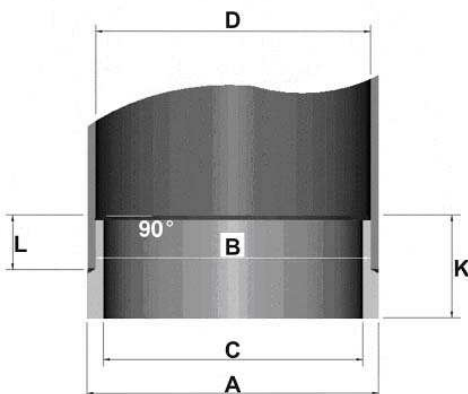

DIA. A	193.7MM
DIA. B	178MM
DIA. C	167MM
DIA. D	181MM
L	44MM
K	95MM

# PNEUMEC

**PNEUMEC COMPANY LIMITED**

1st Floor, Tin On Sing Comm. Bldg., 41-43 Graham St. Central, H.K.

Tel : (852) 2165 9922

Website : [www.pneumec.com](http://www.pneumec.com)

Fax : (852) 2165 9982

email : [info@pneumec.com](mailto:info@pneumec.com)